



MISTMAX PRO

MISTMAX PRO

A Water Mist fire fighting skid for your UTV
or Rapid Intervention fire fighting vehicle



CONTACT
(+971) 434 53452



WEBSITE
FIREBUGGROUP.COM



EMAIL
INFO@FIREBUGGROUP.COM



The ideal rapid response
Fire Fighting system.



Compact



Cost Effective



Environmentally friendly



Reliable



Highly effective

A modular and powerful self contained fire pump unit,
offered as a complete set or in modules to suit the customer
requirements. Ideal as an initial or rapid response fire
fighting unit.

The modules include:

1. Nozzles
2. Engine & Pump & Controls
3. Foam tanks, introducer & Mixer
4. Hose Reel & Manual winder
5. Enclosure or skid
6. Various tanks options
7. Locker

Use our Quotivator to configure your
customised system

www.quotivator.com

MIST MAX



Visit Quotivator.com
to Build your Specification



NOZZLE



FOAM OPTOIN



HOSE REEL

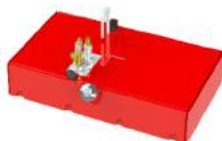

TANKS



**ENGINE PUMP SET
& CONTROL PANEL**

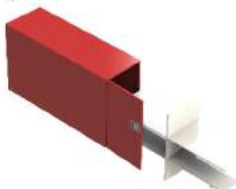

LOCKERS



SOLUTION

THE FIRE TRIANGLE

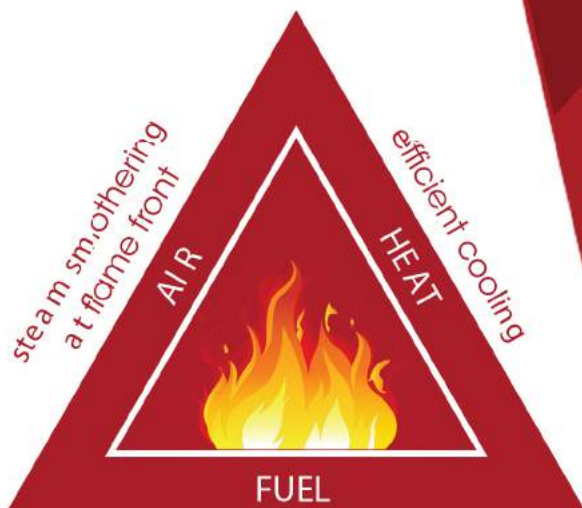

3 elements that are required for a fire to ignite.
Remove any 1 of these elements and the fire will be extinguished.



By applying low pressure fine water droplets, known as "watermist" over, around and into the flame, our Watermist technology suffocates the fire. As the mist converts to steam it reduces the oxygen, simultaneously reducing the temperature at the source of the fire, therefore eliminating the production of flammable gases (free radicals). Having reduced the oxygen and cooled the fire, the flames are extinguished.

The Watermist technology generates a consistent droplet size of around 50 - 75 microns, which equates to an excess of 1,910,828,025 droplets from 1L of water giving a surface area of 120 sqm.

This provides a large surface area for the successful exchange of energy, approximately 2592 kJ/kg, which is responsible for the rapid cooling of the fire.

1. Heat is applied to a combustible material, the temperature of the material rises and free radicals begin to form.

2. Free radicals and gases become airborne, and begin to bond with oxygen in the air. Once there is sufficient amount of gas formed, it ignites (Pyrolysis).

3. The gases burn, generating heat and forming more free radicals.

4. FireBug mist is discharged removing 2 of the 3 triangle elements.

5. The fire is extinguished. Steam (inert) formed by the mist during extinguishing continues to evaporate, dissipating the heat and oxygen from the fire source, cooling the material to prevent re-ignition.

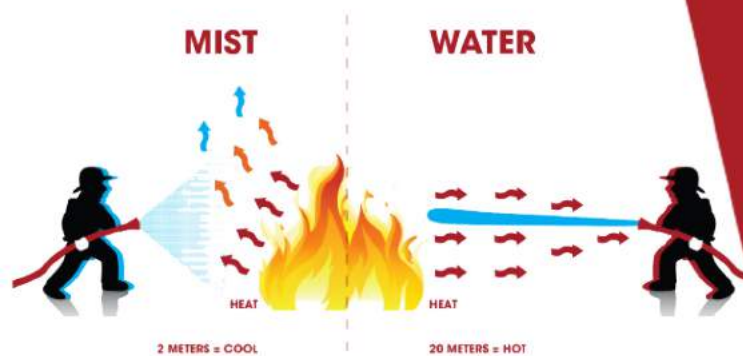

NUMBER OF DROPLETS IN 1 L WATER	DIAMETER OF DROPLET	SURFACE AREA (M²) CREATED FROM 1 L
1	0,12 (12 cm)	0,05
8 841 941	0,0006 (600 microns)	10
1 909 859 317	0,0001 (100 microns)	60
15 278 874 537	0,00005 (50 microns)	120
122 230 996 295	0,000025 (25 microns)	240
1 909 859 317 103	0,000010 (10 microns)	600

The FireBug Mini Nozzle is supplied as standard which is a robust anodized alloy construction pistol grip gun with easy well know on/off valve technology. The nozzle is fitted with 2 filters for protection against dirty water.

FireBug Watermist technology is on the nozzle tip where flow is controlled from Jet to mist by a simple twist grip.

The nozzle generates 55-100micron water mist at an optimum working pressure of 15 - 20s bar.

The Nozzle head is protected by a strong robust EPDM rubber guard making it robust and durable against the bangs and bumps in the world of fire fighting.

The nozzle is coupled to the hose by a quick release coupling.

The Mini nozzle is safe on majority of types of fires including electrical, liquid, oils, certain metals due to the water mist technology.

NOZZLE - CHANGE FROM JET TO MIST CONTROLLED BY TWIST GRIP ON THE BRANCH

Flow Rate:	Approx. 35litres/min jet mode Approx. 30litres/min Mist mode
Throw Distance:	Approx. 12-14m jet mode Approx. 6-8m Mist mode
Working Pressure:	20 bars
Fire Fighting Capability:	A class fire (solids) B Class (Liquids) C Class (Gas) E Class (Electrical fires) F Class (Fat) Fires

MINI NOZZLE



Visit Quotivator.com
to Build your Specification



The FireBug patent Mongoose Rapid Cooling Nozzle is an optional extra lance for external fire fighting and cooling of compartments.

The lance is a robust anodized alloy construction pistol grip gun with easy well know on/off valve technology. The nozzle is fitted with 2 filters for protection against dirty water.

The lance has a retractable nozzle tip for easy deployment through a premade orifice or entry point into any compartment. A protective screen plate is fitted to prevent any debris or heat radiation as well as to act as a stopper for the fire fighter and to provide stability.

The nozzle is coupled to the hose by a quick release coupling.

Brand/Model:	Firebug Mongoose Attack misting system
Material:	Alloy
Optimum Operating Pressure:	6 bars
Flow:	nominal 60 lpm
Inlet:	63.5mm male instantaneous
Length:	1200 mm
Weight:	4.2 kg

MONGOOSE



Visit Quotivator.com
to Build your Specification



FireBug™

HOSE REEL



High Performance smooth water flow hose reel made from co-polymer plastic for a much longer life than most conventional reels. The Reel has carefully designed water flow paths to maximise output by optimising friction, waterflow and pressure.

The standard hose reel supplied with 30 meter ½ Inch high pressure kink free hose exceeding EN853 standard connected at both ends of the hose with Quick release fittings.

The Reel is supplied with a manual front winding mechanism to allow quick, clean & easy rewinding. The winder is supported by a manual gearbox to increase the torque and reduce the amount of effort required for winding and increase the speed of hose winding.

Supplied with or without the outer casing structure. The outer casing structure is Steel With epoxy powder coating paint and 2 easy access latched doors from Hose Reel

High Performance smooth water flow hose reel made from co-polymer plastic for a much longer life than most conventional reels. The Reel has carefully designed water flow paths to maximise output by optimising friction, waterflow and pressure.

The standard hose reel supplied with 30 meter ½ Inch high pressure kink free hose exceeding EN853 standard connected at both ends of the hose with Quick release fittings.

The Reel is supplied with a manual front winding mechanism to allow quick, clean & easy rewinding. The winder is supported by a manual gearbox to increase the torque and reduce the amount of effort required for winding and increase the speed of hose winding.

Supplied with or without the outer casing structure. The outer casing structure is Steel With epoxy powder coating paint and 2 easy access latched doors from top and side making it easily accessible to the reel for maintenance and cleaning or emergency manual hand winding. The outer casing is ventilated to encourage rapid drying should any water spill occur during winding and usage.

The structure is fitted with hose guide rollers and a convenient hose entry point assisting in rapid smooth extraction of the hose and even distribution of hose when rewinding.

The Structure is supplied with a internal bracket to hold the reel winder handle and a separate bracket internally to hold the nozzle if detached. An external nozzle bracket is also supplied to securely hold the nozzle when connected to the hose.

- Easy extraction and rewind
- Secure storage brackets
- Rapid drying
- With or without outer casing
- Non kink high pressure hose
- Long Life low maintenance
- Geared hose winder
- Light weight



TECHNICAL SPECIFICATION

Reel:	CoPolymer
Fittings:	Stainless, Aluminum & Brass
Structure:	Alloy Steel Epoxy Powder Coated
Open Door Dimensions:	1129mm(H) x 904 (W) x 600mm(D)
Closed Door Dimensions:	544mm (H) x 356mm(W) x 600mm(D)
Hose:	30meter 160bar non kink hose
Colour:	Red RAL 3000 as standard with black hose.(Any colour on request)
Weight:	27kg

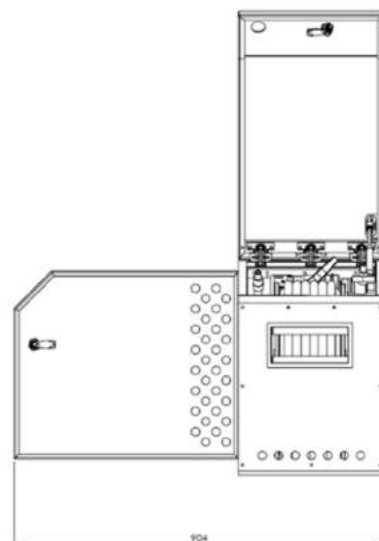
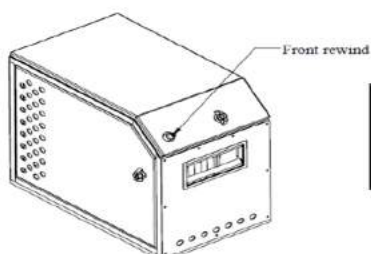
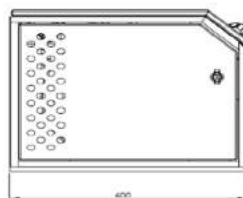
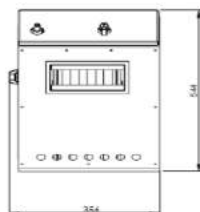
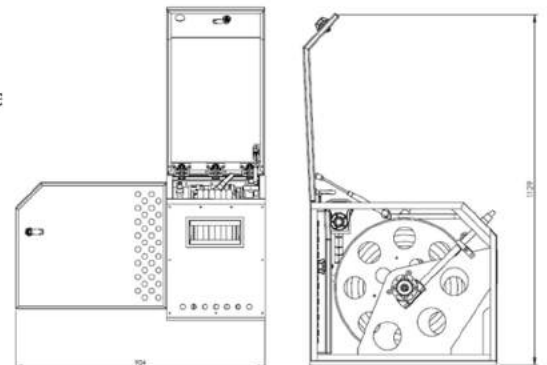
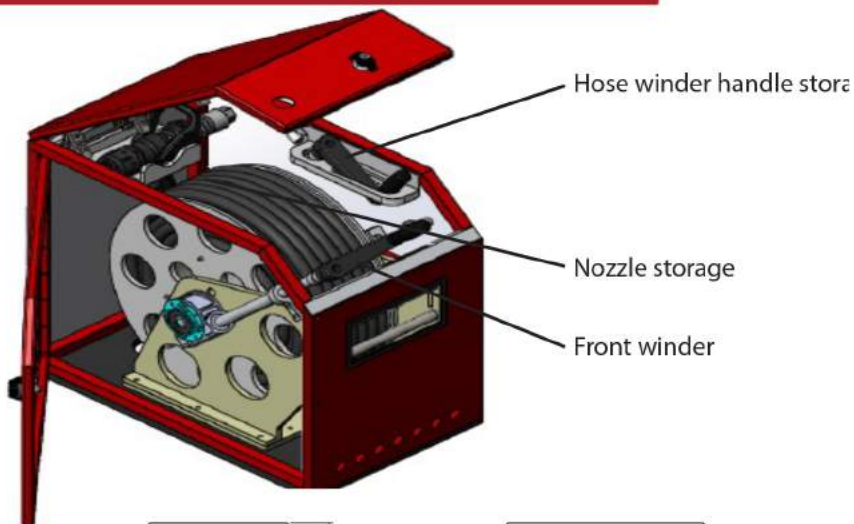

PUMP UNIT



The MistMax pump unit is a CE certified, well engineered combination of a the world renown Briggs & Stratton electric start petrol engine, gearbox and 40 bar diaphragm pump which creates a water pulsing effect to enhance the mist output.

The pump contains a pre-set pressure regulator and gauge to provide a steady flow of water at the right pressure through the hose reel to the nozzle where the mist or jet flow is controlled.

The pump, engine, water and foam controllers are well presented on 2 neat and concealed control panels which are clearly illuminated by LED lights on each panel for use in the dark. All switches are robust & waterproof and designed for easy use with or without fire fighter gloves.

The unit contains an hour meter for easy tracking for maintenance and optional fuel and water gauges can be included on the control panels too. The structure



securely holds the optional foam tank and system and the integrated fuel tank.

The structure is designed and built with an easy access point and pipe with quick release coupling to connect to a water source tank or other.

The unit is usually provided in a copolymer plastic anti vibration easy mountable base and steel epoxy powder coated structure with easy accessible rapid entry doors from side and top for easy access and maintenance. The side doors are ventilated for enhanced cooling and the structure is fitted with an electrical extraction fan.

The unit attaches to the hose reel module by quick release hose couplings and a few easy to fit attaching bolts.

The unit can also be supplied on a simple skid without the structure or hose reel. All options are designed for easy mounting to any surface, tank or slide tray.

The stainless steel, E-ductor foam system an optional extra on the mistmax system offering a preset 3 or 6% foam concentrate gravity fed induction system.

2 x 6Litre co polymer foam tanks, A and B are fitted onto the pump structure with easy access for convenient filling. The correct percentage % of foam is then gravity fed through a mixing inductor into the main water line. The 2 foam tanks allow the system to be filled with 2 different types of foam.

The correct foam tank is activated by the simple electromechanical switch on the main control panel which opens the relevant tank electronically.

FOAM SYSTEM

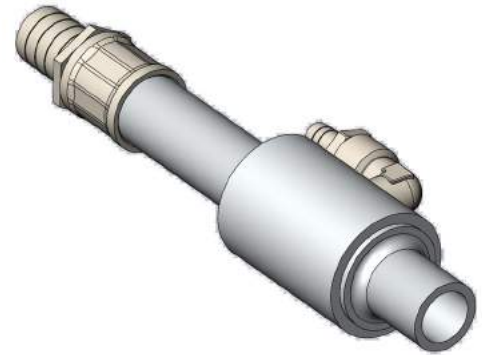

A selection of painted or unpainted, Co-polymer highly engineered water tanks are available specifically for the mistmax with pre-fitted plumbing and mounting points of the mistmax and hose reel unit and for easy connection. Copolymer is an almost indestructible plastic type material with anti bacterial properties.

The tanks come with options of inlet valves and connections as well as filling flow and pressure controllers as optional extras to allow the tank to be filled from a hydrant or various water sources.

The tanks are specially manufactured with baffles for safety and strength, as well as an overflow and /or pressure relief mechanisms. Lifting and loading has also been considered on the larger tanks with fork lift mounting points.

Water level viewing panels can be fitted as an optional extra, as well as water level sensors if utilizing an electrical water gauge on the control panel.

The tanks come standard with a water flush valve for cleaning and maintenance.

As standard the tanks are supplied in white however any standard RAL colour is available for epoxy powder coating.

Pages: 8-12

TANKS



STORAGE AND LOCKER SYSTEMS

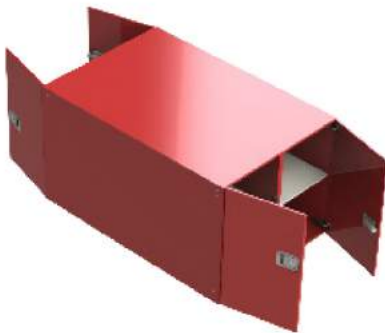
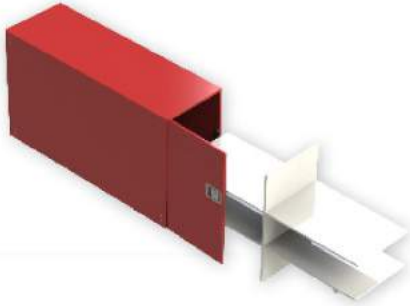

The mistmax modular unit is designed to accommodate various bolt-on storage structures.

Manufactured from the almost indestructible Co-polymer there are multiple options available to suit the size of the water tank and equipment storage requirements.

Manufactured with tough proven hinge and latching mechanisms to withstand slamming, rapid opening and closing and well as wind. The latching mechanism can either be locking or non locking.

A range of shelving solutions are available such as 1 door, 2 door, 1 shelf or 2 shelves, through shelves or divided into compartments.

The storage structures are epoxy powder coated paint to match the mistmax in any RAL colour.

Product: MistMax

DATASHEET TABLE

Description: Self Contained & Self Priming Petrol
Low/ Medium Pressure Mist Fire Pump

Flow: 40 Bar Max Pressure
20 Bar Min Pressure

Size & Weight: 1039L x 600W x 56H

Engine: Briggs & Stratton Petrol 6.5HP

Fitting/Size: 1.5" Stortz Coupling or Customers request

Maintenance: Routine Inspection & Annual Service





**MISTMAX
PRO**



**STAY
UP-TO-DATE
WITH US ON SOCIAL MEDIA**



Firebuggroup



Firebuggroup



Firebuggroup



Sales@Firebuggroup.com



Firebuggroup



Firebuggroup



Firebuggroup

**VISIT @ FIREBUGGROUP.COM
INFO@FIREBUGGROUP.COM**

FireBug™

U.A.E. OFFICE

UAE Office: Info@firebuggroup.com AWZ Building Warehouse 4, Ras Al Khor Industrial Area No.2. PO Box 252234 Dubai, U.A.E.
Tel: +971 434 53452

FB FIRE TECHNOLOGIES LTD.

UK Office: Matrix@Dinnington Business Centre, Nobel Way Dinnington, Sheffield S25 3QB, United Kingdom Tel: +44 1909 547070
Fax: +44 8453 884115

FireBug™